

# EVACUATION ROUTE PLAN

# FIRE

## In case of

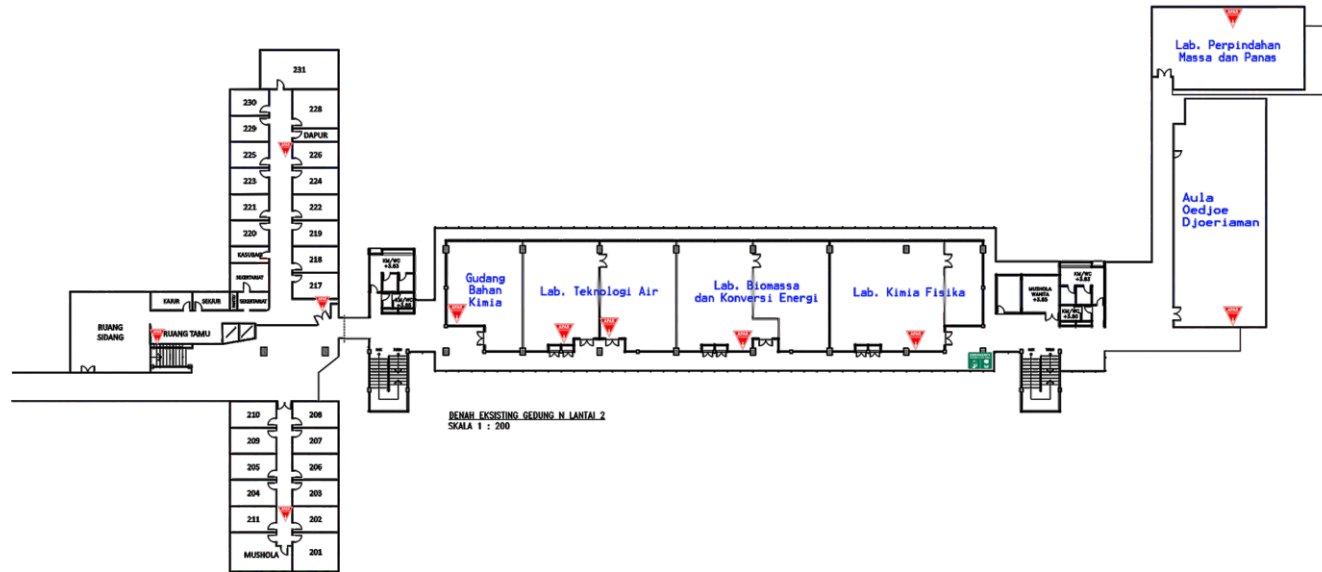

**RESCUE** Rescue yourself and help other who are in obvious danger. If the room is filled with smoke, crawl along the floor. Do not ever walk through the smoke.

**ALERT** Alert your friends/co-workers and others. Maybe someone is having headsets on or talking on their phone, help and alert them.

**ALARM** Contact the security officer. Tell them who you are, what has happened and where the fire. Or press the emergency button for an automatic fire alarm.

**PUTOUT** If you can avoid putting yourself at risk, start putting out the fire. The emergency plan tells you where the fire extinguishers are.

**EVACUATE** Always take the closest emergency route / exit. Follow the green signs. Always take the stairs, never use the elevators. If you encounter smoke, turn around and find another way out. Walk to the ASSEMBLY POINT

## GEDUNG N LANTAI 2



Jurusan Teknik Kimia  
Fakultas Teknik Industri

hibahK39