

EVACUATION ROUTE PLAN

FIRE

In case of

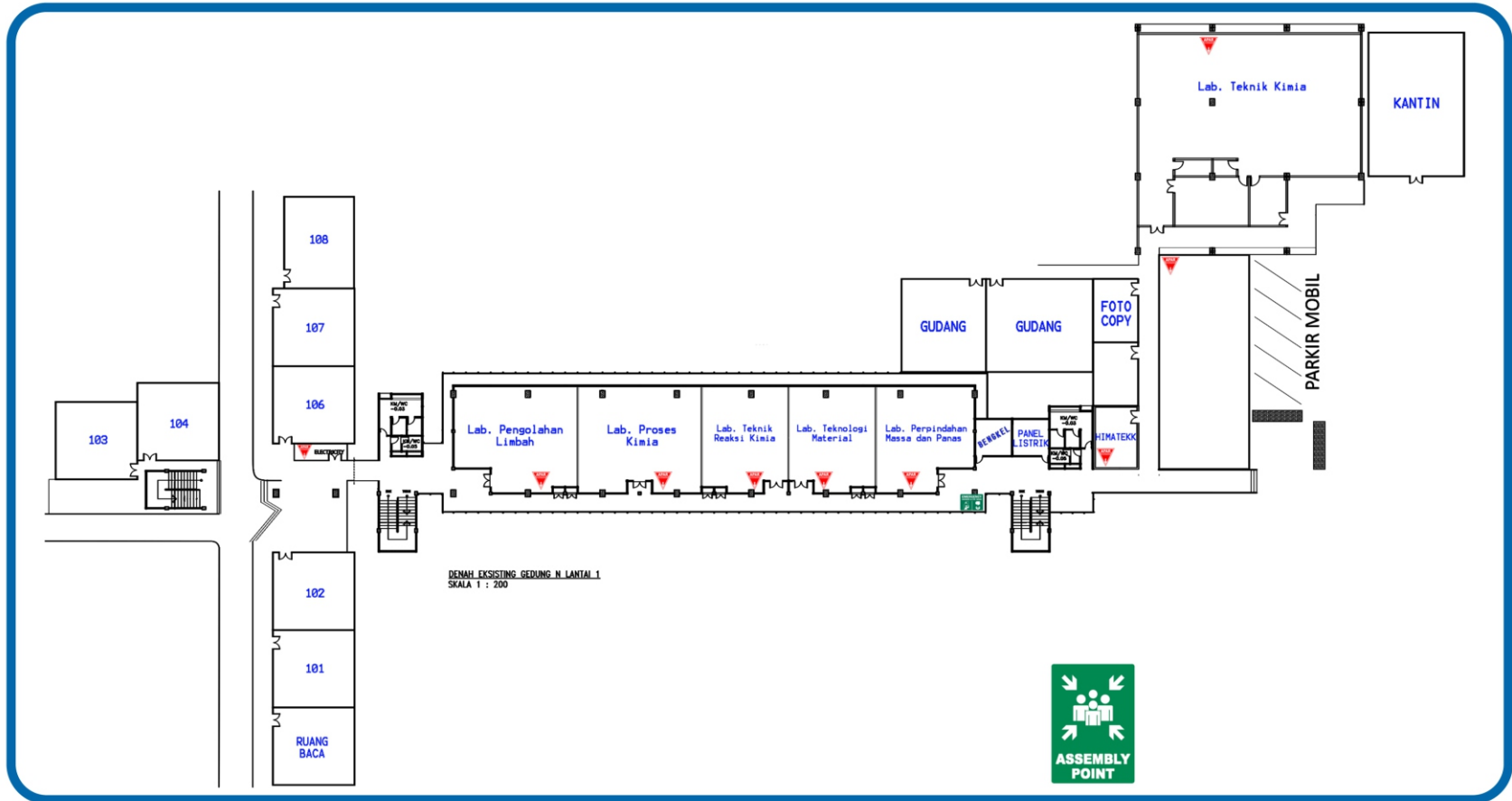

RESCUE Rescue yourself and help other who are in obvious danger. If the room is filled with smoke, crawl along the floor. Do not ever walk through the smoke.

ALERT Alert your friends/co-workers and others. Maybe someone is having headsets on or talking on their phone, help and alert them.

ALARM Contact the security officer. Tell them who you are, what has happened and where the fire. Or press the emergency button for an automatic fire alarm.

PUT OUT If you can avoid putting yourself at risk, start putting out the fire. The emergency plan tells you where the fire extinguishers are.

EVACUATE Always take the closest emergency route / exit. Follow the green signs. Always take the stairs, never use the elevators. If you encounter smoke, turn around and find another way out. Walk to the ASSEMBLY POINT

GEDUNG N LANTAI 1



Jurusan Teknik Kimia
Fakultas Teknik Industri

hibahK39